

HCT1

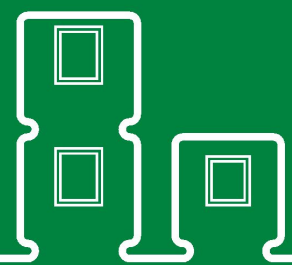

HCT1 is a functional health testing module with an office and personnel room with small kitchen, WC/shower and entrance corridor

PRODUCT SPECIFICATION:

Building area	24,3 m ²
Total area, of which	20,5 m ²
- Entrance	1,5 m ²
- WC/Shower	2,5 m ²
- Personnel Room	9,0 m ²
- Office	7,5 m ²
Transportation measures	2950 x 8570 x 3000 mm
Inside Measures	2620 x 8120 x 2400 mm
Weight	ca' 5600 kg
Roof angle	1:60

INCLUDING:

- C01 - Galvanized steel profile frame, liftable with forklift and crane
- F37 - Clothes hanger hooks 4 pc on wall
- F40 - Minikitchen set, incl.; fridge, stove, sink and mixer
- F50 - Cabinet over Minikitchen
- F52 - Cabinet with Shelf beside Minikitchen
- F82 - Microwave oven
- F90 - Mirror on wall
- E38 - Light external, with daylight sensor and time programming
- E50 - Timer socket 0-120 min
- P52 - Ceramic basin with mixer
- P65 - Shower cabin with mixer, shower lift and curtain
- P70 - Toilet seat and toilet paper roll holder
- H36 - Water heater 80 L

AVAILABLE AS ADD ON PRODUCTS:

- F05 - Dining table for 4 persons
- F10 - Desk with drawer cabinet
- F20 - Chair customer/dining
- F22 - Chair office
- S22 - Locking bar for external door
- S25 - SmartLock for doors
- S05 - Window grid 1200x1200 mm
- S18 - Venetian blind 1200x1200 mm
- H50 - Heat Pump/Air Conditioning (Air-Air)
- V35 - Wall fan OUT-100/IN-100 with heat recovery
- E10 - Electrical connection cable 32A when campus building
- Carport Roof elements and its supporting structures

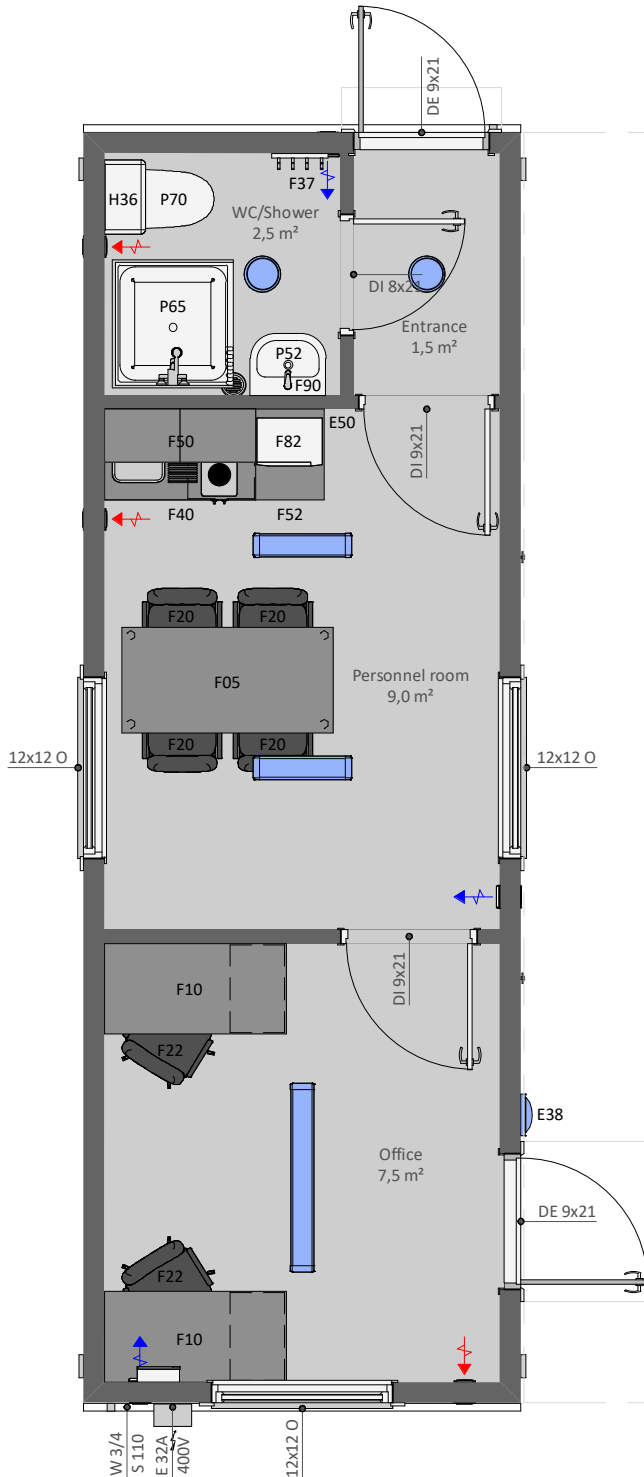

Producer: