

# HCHW22W

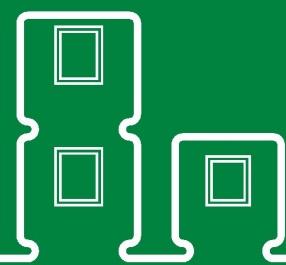

**HCHW22W** is a functional temporary hospital module with central corridor, two ward rooms and WC/shower for single patient

**PRODUCT SPECIFICATION:**

Building area	41,8 m <sup>2</sup>
Total area, of which	37,5 m <sup>2</sup>
- Ward Room	12,0 m <sup>2</sup>
- WC/Shower	2,5 m <sup>2</sup>
- Corridor	8,5 m <sup>2</sup>
- WC/Shower	2,5 m <sup>2</sup>
- Ward Room	12,0 m <sup>2</sup>
Transportation measures	3490 x 12200 x 3000 mm
Inside Measures	3210 x 11710 x 2400 mm
Weight	ca' 8600 kg
Roof angle	1:100

**INCLUDING:**

- C01 - Galvanized steel profile frame, liftable with forklift and crane
- F36 - Clothes hanger hook 1 pc on wall
- F37 - Clothes hanger hooks 4 pc on wall
- F90 - Mirror on wall
- P52 - Ceramic basin with mixer
- P68 - Shower area set, incl. floor drainage, mixer, shower lift and curtain
- P70 - Toilet seat and toilet paper roll holder
- H20 - Electrical towel dryer
- H36 - Water heater 80 L

**AVAILABLE AS ADD ON PRODUCTS:**

- F20 - Chair visitor
- S05 - Window grid 1200x1200 mm
- S18 - Venetian blind 1200x1200 mm
- H50 - Heat Pump/Air Conditioning (Air-Air)
- V35 - Wall fan OUT-100/IN-100 with heat recovery
- E10 - Electrical connection cable 32A when campus building
- Antibacterial finishing materials
- Antibacterial ventilation system
- Pipeline for medical gas

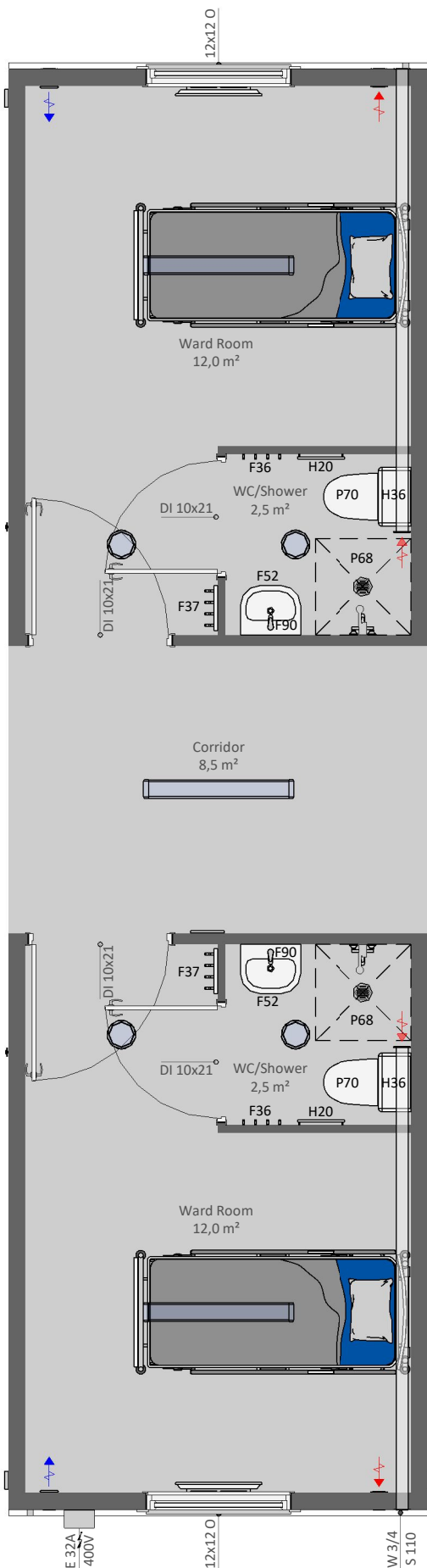

Producer: