

HABT14

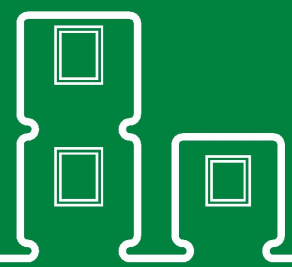

HABT14 is a functional habitat module with bedroom for max 4 persons, an entrance hall, a WC with shower and a dining room with small kitchen

PRODUCT SPECIFICATION:

Building area	24,3 m ²
Total area, of which	21,0 m ²
- Entrance Hall	2,5 m ²
- WC/Shower	3,0 m ²
- Kitchen/Dining	8,0 m ²
- Bedroom	7,5 m ²
Transportation measures	2950 x 8570 x 3000 mm
Inside Measures	2620 x 8120 x 2400 mm
Weight	ca' 5400 kg
Roof angle	1:60

INCLUDING:

- C01 - Galvanized steel profile frame, liftable with forklift and crane
- F05 - Dining table for 4 persons
- F20 - Chair customer/dining
- F26 - Bed double-bunk 900x2000mm with mattress
- F36 - Clothes hanger hook 1 pc on wall
- F39 - Clothes hanger hooks 8 pc on wall
- F40 - Minikitchen set, incl.; fridge, stove, sink and mixer
- F50 - Cabinet over Minikitchen
- F52 - Cabinet with Shelf beside Minikitchen
- F82 - Microwave oven
- F90 - Mirror on wall
- P50 - Ceramic basin with mixer
- P65 - Shower cabin with mixer, shower lift and curtain
- P70 - Toilet seat and toilet paper roll holder
- H34 - Water heater 50 L (drainable)

AVAILABLE AS ADD ON PRODUCTS:

- S22 - Locking bar for external door
- S25 - SmartLock for doors
- S05 - Window grid 1200x1200 mm
- S18 - Venetian blind 1200x1200 mm
- H50 - Heat Pump/Air Conditioning (Air-Air)
- V35 - Wall fan OUT-100/IN-100 with heat recovery
- E10 - Electrical connection cable 32A when campus building
- External connections when campus building
- Internal connections when campus building

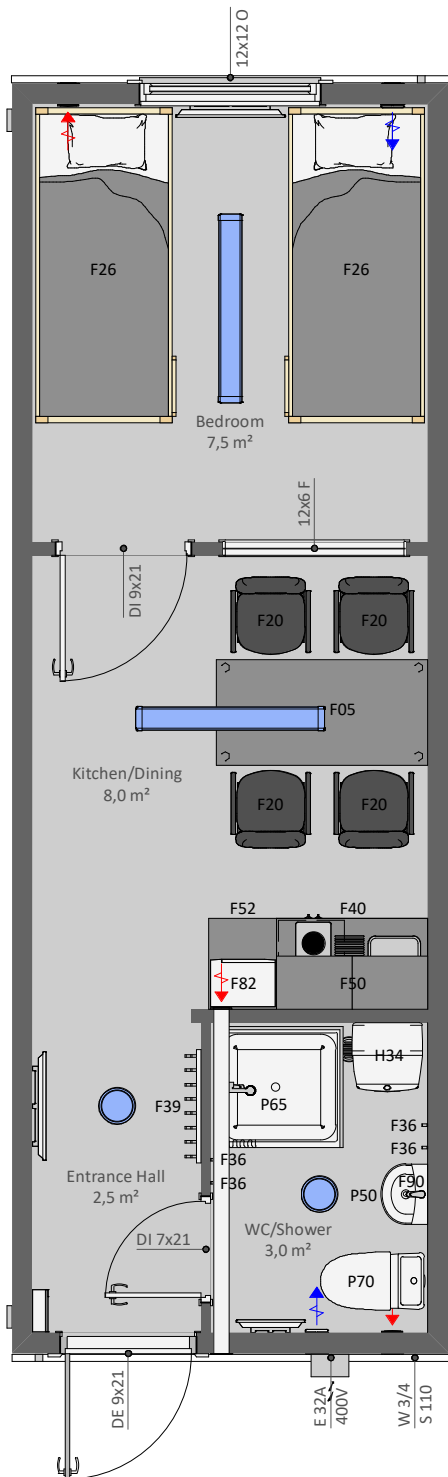

Producer: